

# Installation Manual

BMW 5 SERIES 4DR  
BMW-5SER-4-D



## COMPONENTS INCLUDED

## SHADES

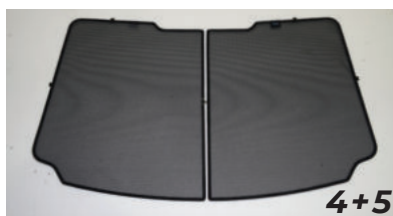
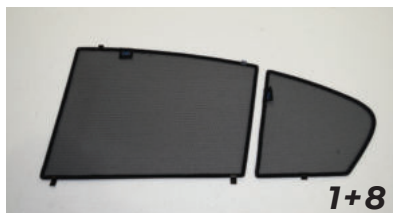
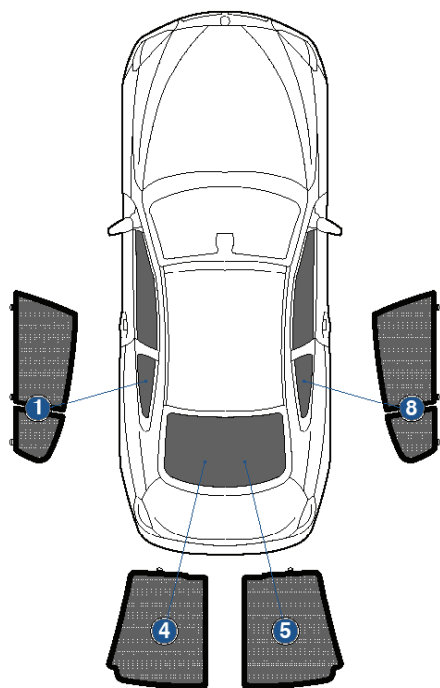

## FIXING CLIPS



CL-M02 x 4



CL-M03 x 6



CL-M04 x 2



CL-M12 x 2



CL-M14 x 1

# Side Shade (A) Installation

BMW 5 SERIES 4DR  
BMW-5SER-4-D

COMPONENTS NEEDED:

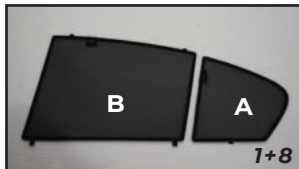

## STEP #1

ATTACH CLIPS ON SHADE EDGES



## STEP #2

POSITION THE SIDE SHADE



## STEP #3

INSERT CLIPS BEHIND INTERIOR TRIM



## STEP #4

ENSURE SECURELY FITTED IN PLACE

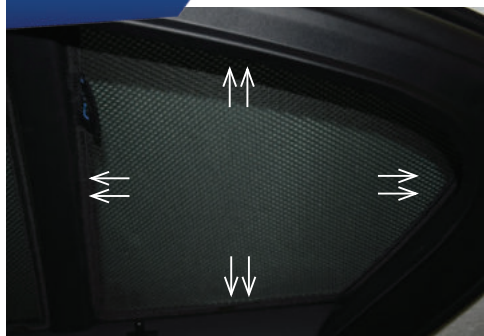

**CAR**  
SHADES

# Side Shade (B) Installation

BMW 5 SERIES 4DR  
BMW-5SER-4-D

COMPONENTS NEEDED:

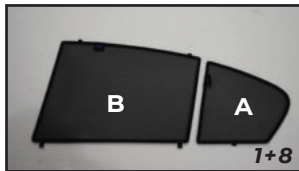

CL-M02 x 2



CL-M03 x 2

## STEP #1

ATTACH CLIPS ON SHADE EDGES

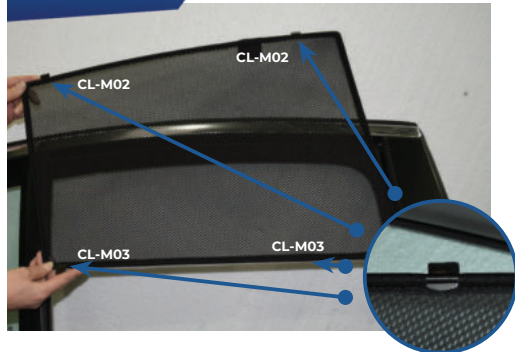

## STEP #2

POSITION THE SIDE SHADE

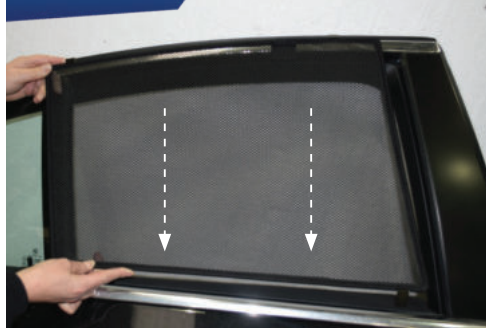

## STEP #3

INSERT CLIPS BEHIND INTERIOR TRIM



## STEP #4

ENSURE SECURELY FITTED IN PLACE

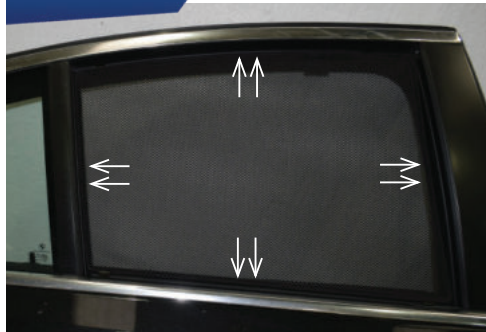

# Rear Shade Installation

BMW 5 SERIES 4DR  
BMW-5SER-4-D

## COMPONENTS NEEDED:



### STEP #1

ATTACH CLIPS ON SHADE EDGES



### STEP #2

POSITION THE REAR SHADE



### STEP #3

INSERT CLIPS BEHIND INTERIOR TRIM



### STEP #4

REPEAT THE PROCESS ON OTHER SHADE



### STEP #5

ENSURE SECURELY FITTED IN PLACE

