

# Installation Manual

VOLVO S90 4DR  
VOL-S90-4-A



## COMPONENTS INCLUDED

## SHADES

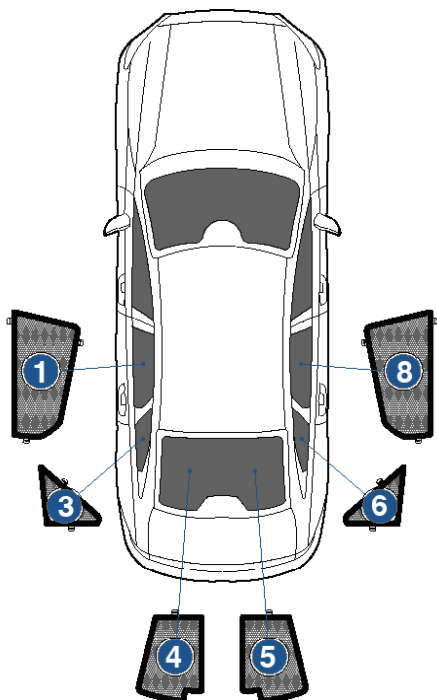

## FIXING CLIPS



CL-M02 x 8



CL-M03 x 2



CL-M12 x 6



CL-M14 x 1

# Side Shade Installation

VOLVO S90 4DR  
VOL-S90-4-A

## COMPONENTS NEEDED:



### STEP #1

ATTACH CLIPS ON SHADE EDGES

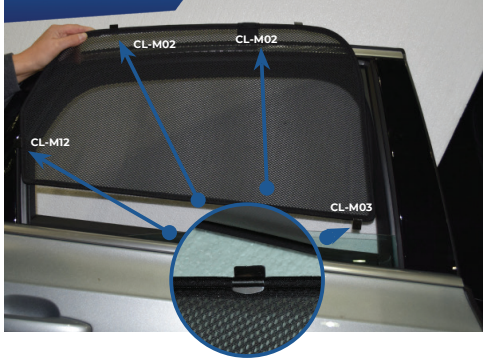

### STEP #2

POSITION THE SIDE SHADE

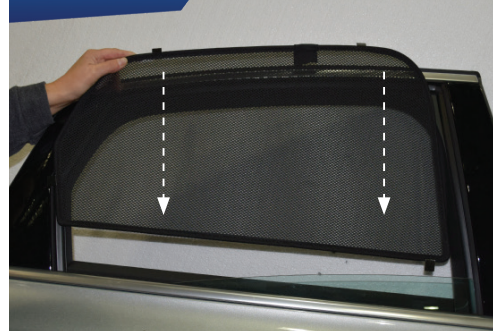

### STEP #3

INSERT CLIPS INSIDE WEATHERSTRIP

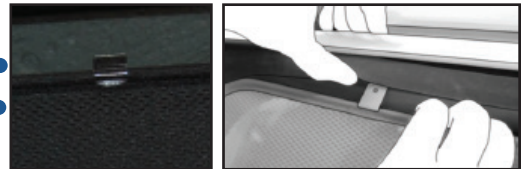
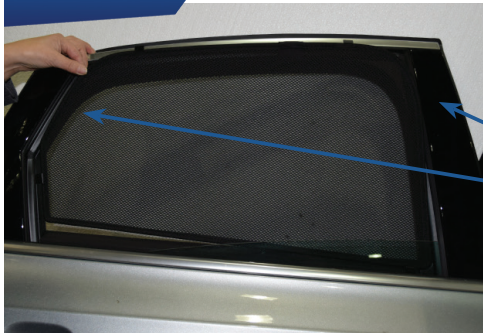

### STEP #4

ENSURE SECURELY FITTED IN PLACE

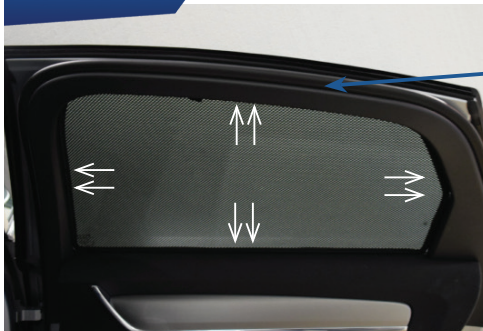

**CAR**  
SHADES

# Quarter Light Shade Installation

VOLVO S90 4DR  
VOL-S90-4-A

COMPONENTS NEEDED:

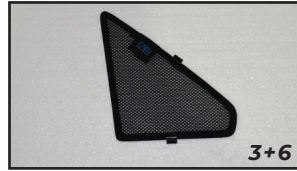

## STEP #1

ATTACH CLIPS ON SHADE EDGES



## STEP #2

INSERT CLIPS BEHIND INTERIOR TRIM



## STEP #3

ENSURE SECURELY FITTED IN PLACE





# Rear Shade Installation

VOLVO S90 4DR

VOL-S90-4-A

COMPONENTS NEEDED:



## STEP #1

ATTACH CLIPS ON SHADE EDGES



## STEP #2

POSITION THE REAR SHADE



## STEP #3

INSERT CLIPS BEHIND INTERIOR TRIM



## STEP #4

REPEAT THE PROCESS ON OTHER SHADE



## STEP #5

ENSURE SECURELY FITTED IN PLACE



**CAR**  
SHADES