

# Installation Manual

VOLVO V90 EST  
VOL-V90-E-A



## COMPONENTS INCLUDED

## SHADES

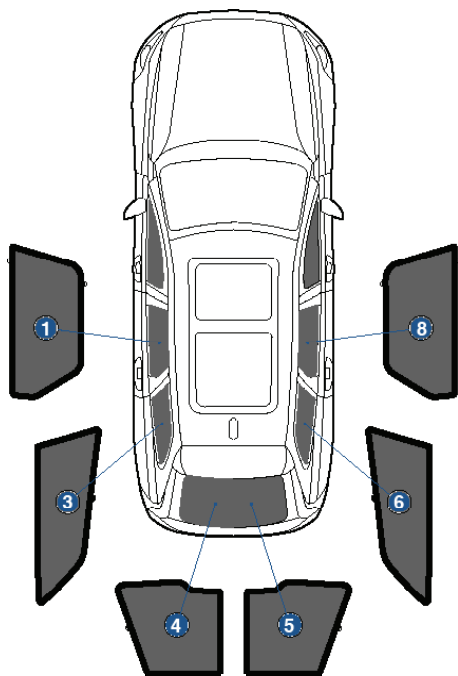

## FIXING CLIPS



CL-M02 x 10



CL-M12 x 2



CL-M13 x 2



CL-M14 x 1

# Side Shade Installation

VOLVO V90 EST  
VOL-V90-E-A

## COMPONENTS NEEDED:



### STEP #1

ATTACH CLIPS ON SHADE EDGES

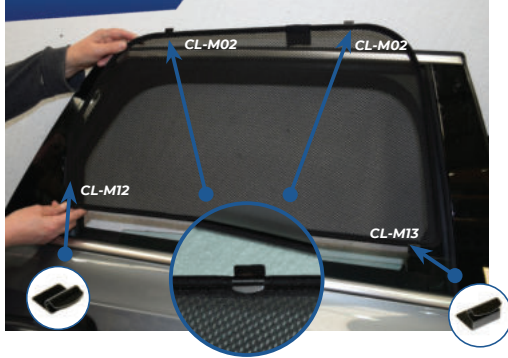

### STEP #2

POSITION THE SIDE SHADE

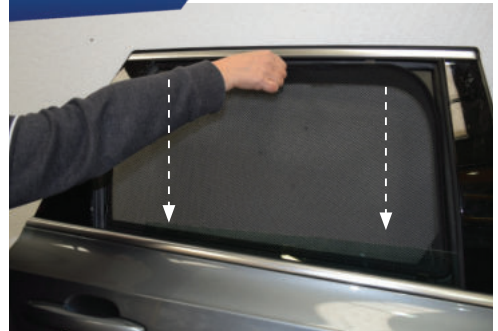

### STEP #3

INSERT CLIPS INSIDE WEATHERSTRIP

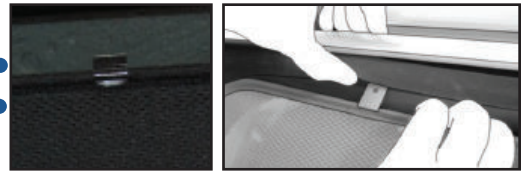
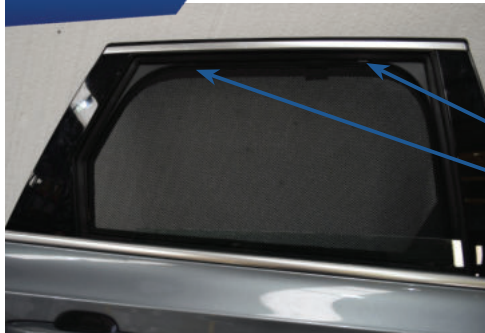

### STEP #4

ENSURE SECURELY FITTED IN PLACE

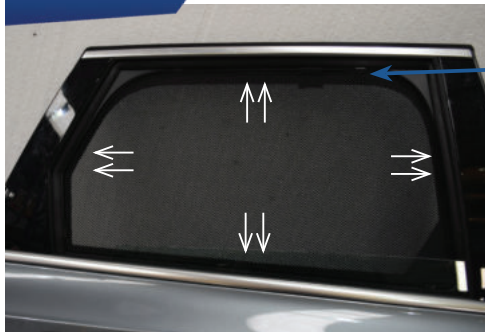

**CAR**  
SHADES

# Quarter Light Shade Installation

VOLVO V90 EST  
VOL-V90-E-A

## COMPONENTS NEEDED:



### STEP #1

ATTACH CLIPS ON SHADE EDGES



### STEP #2

INSERT CLIPS BEHIND INTERIOR TRIM



### STEP #3

ENSURE SECURELY FITTED IN PLACE



# Rear Shade Installation

VOLVO V90 EST  
VOL-V90-E-A

COMPONENTS NEEDED:

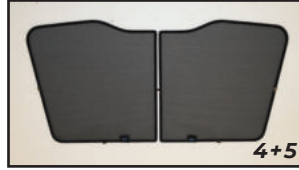

## STEP #1

ATTACH CLIPS ON SHADE EDGES



## STEP #2

POSITION THE REAR SHADE

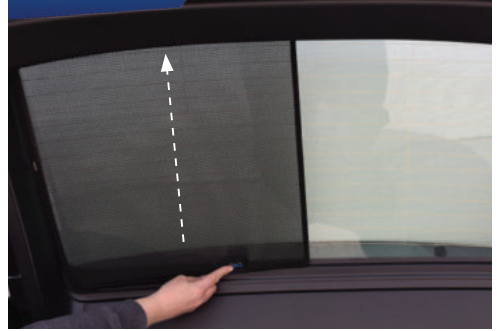

## STEP #3

INSERT CLIPS BEHIND INTERIOR TRIM

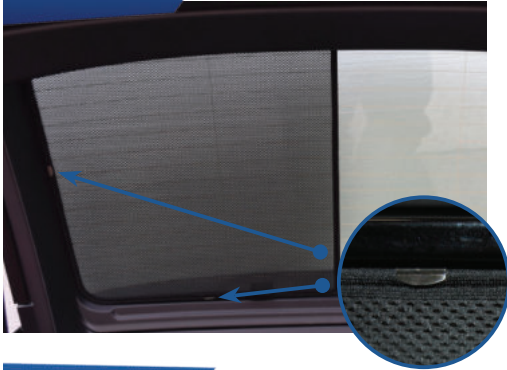

## STEP #4

REPEAT THE PROCESS ON OTHER SHADE

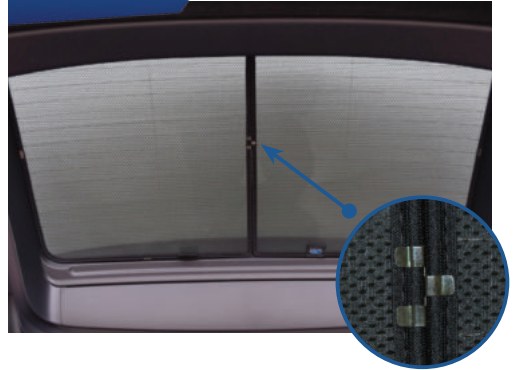

## STEP #5

ENSURE SECURELY FITTED IN PLACE

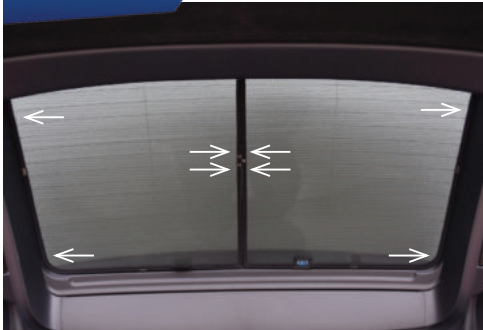

**CAR**  
SHADES