

# INSTALLATION INSTRUCTIONS

**Product name** RAUMTEILER DELUXE

**Product type** Universal divider for luggage and dog guards

**Item no.** 10001433 (optionally additional base plate, item no.: 10001435)

**Attachment** to ROADMASTER DELUXE, item no. 10001413

**Use** Divides the cargo space behind the protection guard

**Version and features** Anodised aluminium profiles, steel powder-coated, stainless steel

**Dimensions** Height: 66 cm, width: 75 to 115 cm (telescopic bars)

**Weight** 4 kg

kleinmetall GmbH

Hainstraße 52

63526 Erlensee

Phone 06183.91120-0

Fax 06183.72152

E-Mail [info@kleinmetall.de](mailto:info@kleinmetall.de)

[www.kleinmetall.de](http://www.kleinmetall.de)

**Please read these instructions carefully and keep them in a safe place.  
Whenever the guard is used, make sure it is correctly installed!**

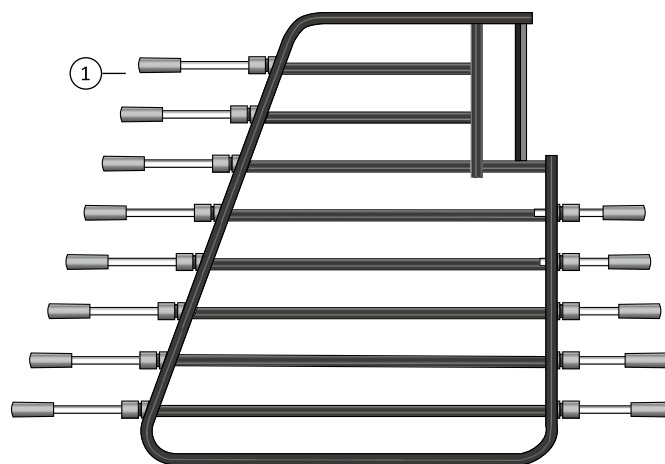
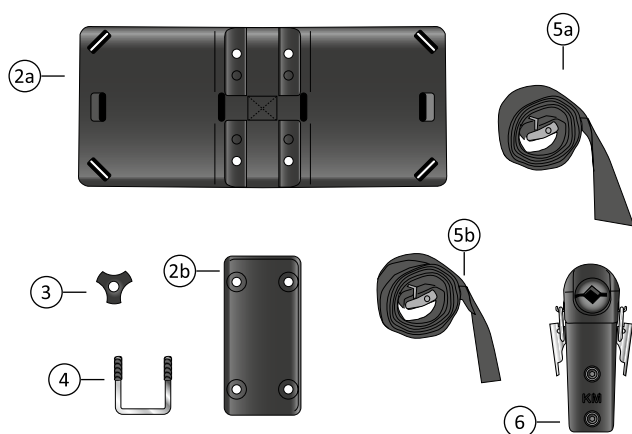

## Parts list

- |   |    |
|---|----|
| 1. Divider pre-assembled with telescopic bars | 1x |
| 2a. Base plate lower part                     | 1x |
| 2b. Base plate upper part                     | 1x |
| 3. Knurled nut                                | 4x |
| 4. U-bolts M8                                 | 2x |
| 5a. Wide lashing strap                        | 1x |
| 5b. Narrow lashing strap                      | 4x |
| 6. Clamping bracket assembled                 | 1x |
| Clamping bracket – exploded-view drawing      |    |
| 7. U-clamp                                    | 1x |
| 8. Phillips screw "big"                       | 2x |
| 9. Clamp shell                                | 1x |
| 10. Clamping ball                             | 1x |
| 11. Pressure shell                            | 1x |
| 12. Bearing element                           | 1x |
| 13. Headless screw M6                         | 1x |
| 14. Hexagon nut M6                            | 2x |
| 15. Bearing segment without clamping bracket  | 1x |
| 16. Bearing segment with clamping bracket     | 1x |
| 17. Allen screw M6                            | 2x |
| 18. Washer                                    | 2x |

## Necessary tools

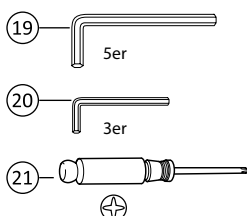

Tools (not included, use the ones  
from ROADMASTER DELUXE)

19. Allen key 5 mm

20. Allen key 3 mm

21. Phillips screwdriver

# INSTALLATION INSTRUCTIONS

## 1 Overview of final state

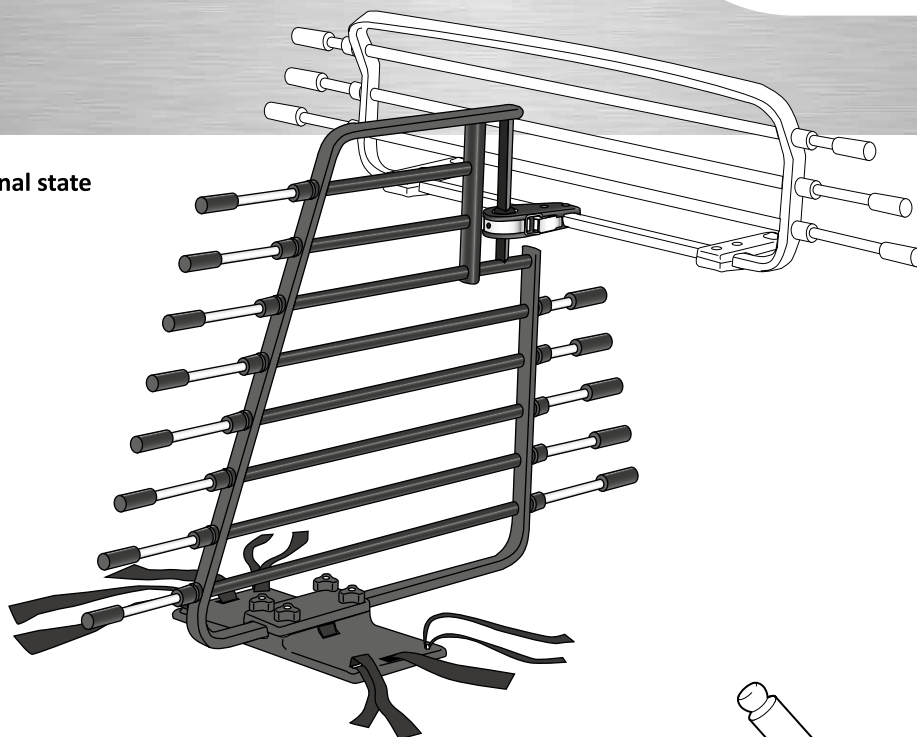

## 2 Open clamping bracket, open ball head part

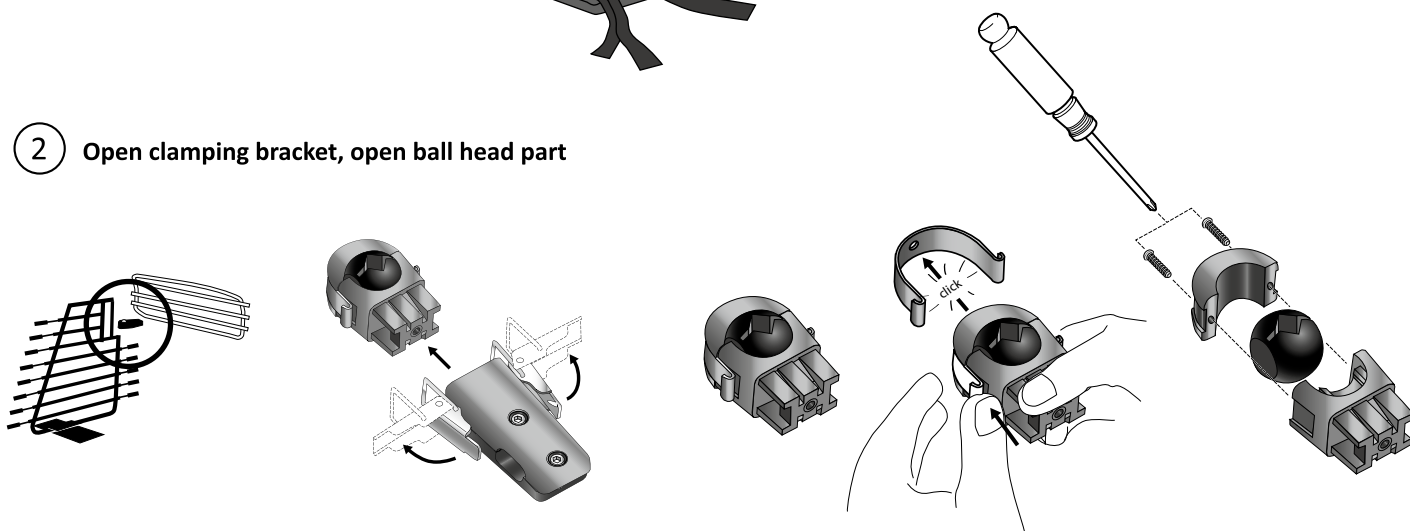

## 3 Fasten ball head to square bar of the divider

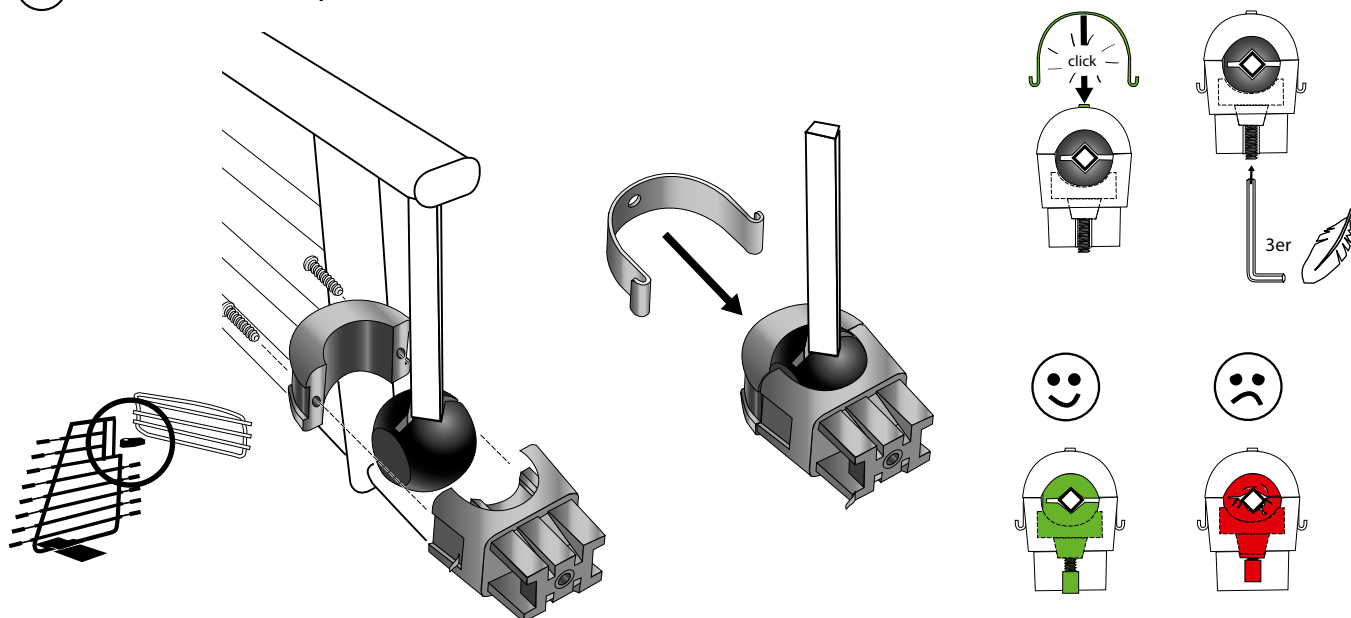

# INSTALLATION INSTRUCTIONS

## ④ Fasten clamping part to "ROADMASTER DELUXE"

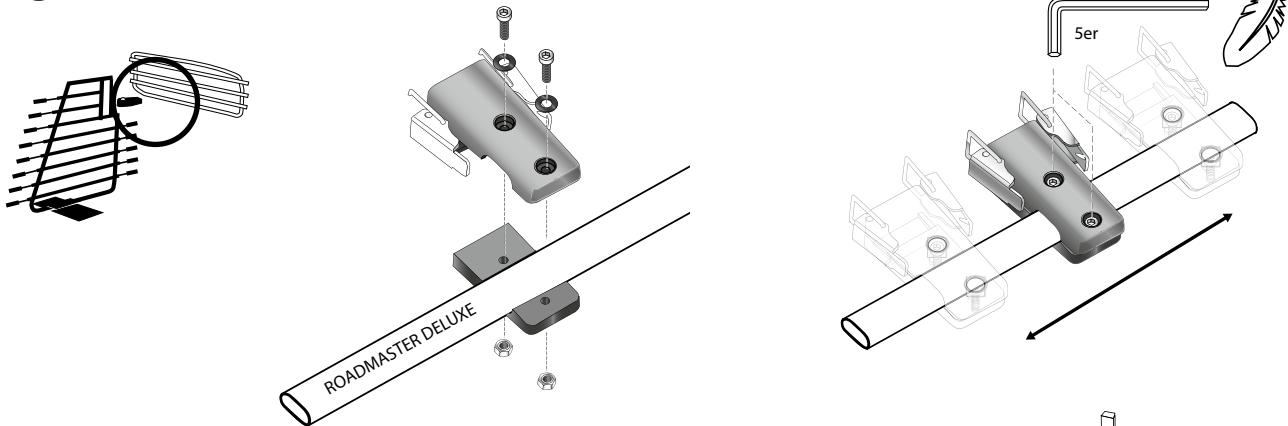

## ⑤ Find position in the car boot

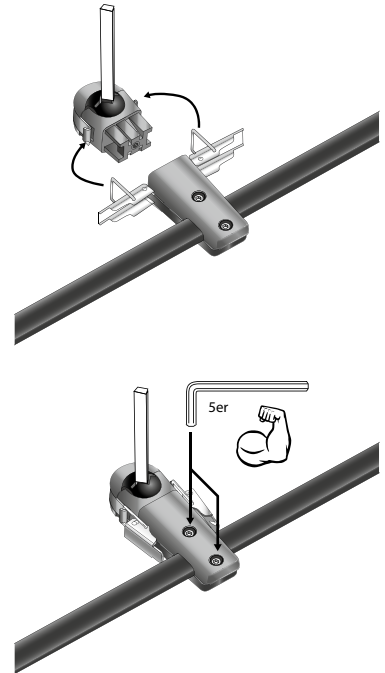
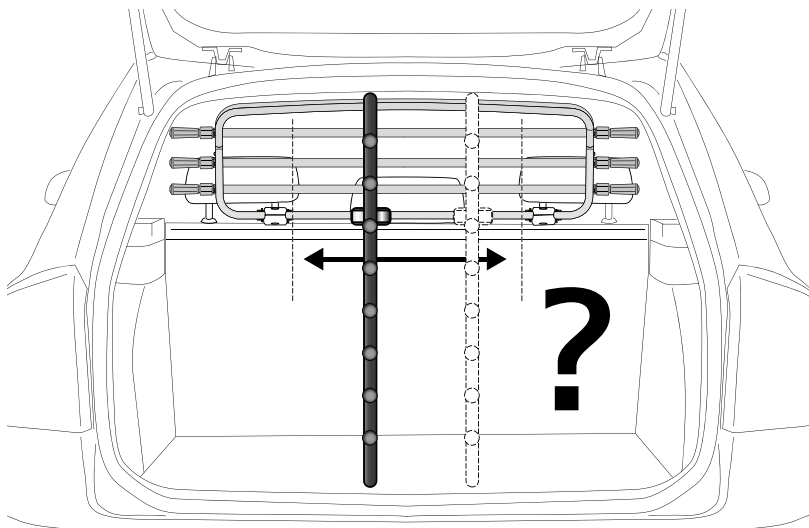

## ⑥ Position of base plate

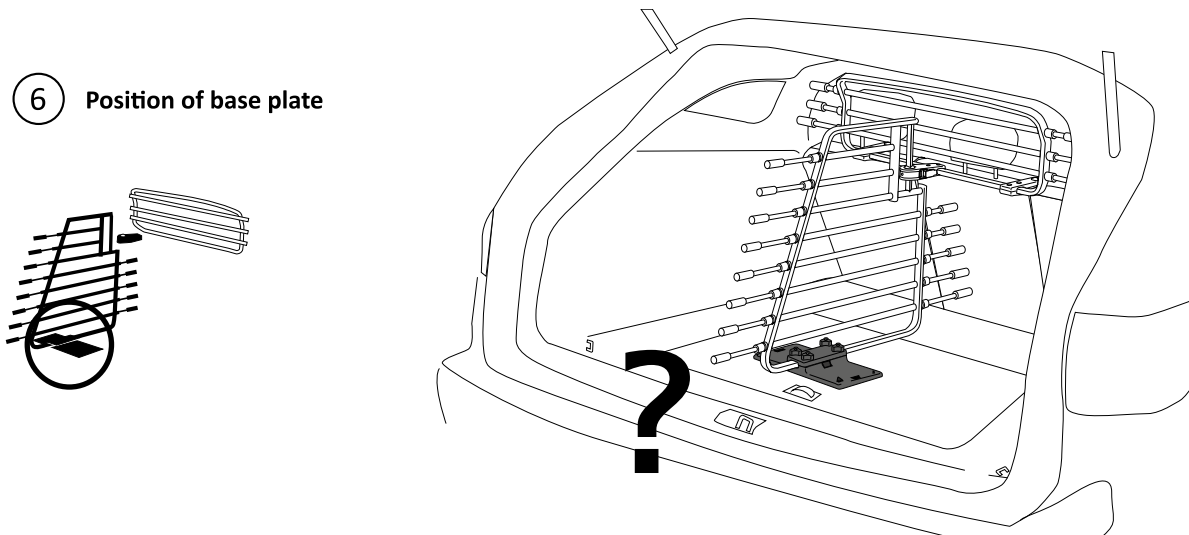

# INSTALLATION INSTRUCTIONS

## 7 Position of base plate – DO NOT PLACE ON PLASTIC PARTS – risk of scratching

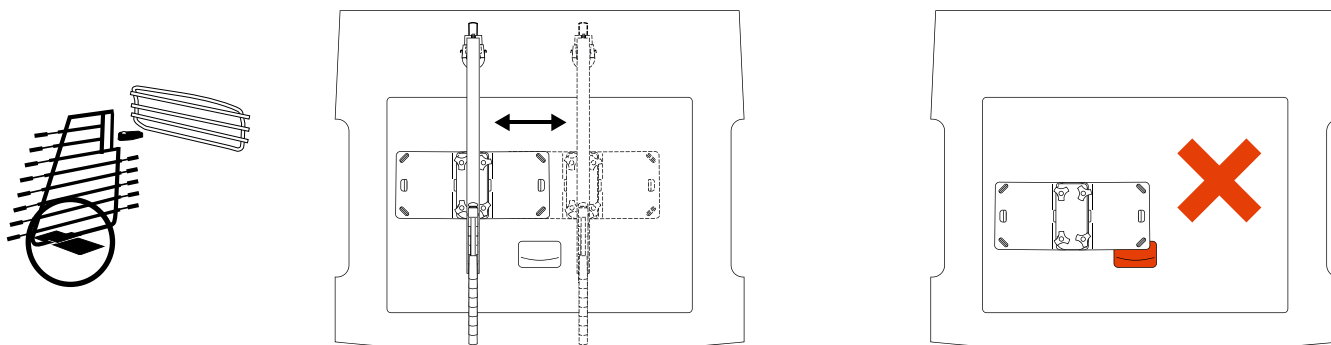

## 8 Fastening options with lashing straps

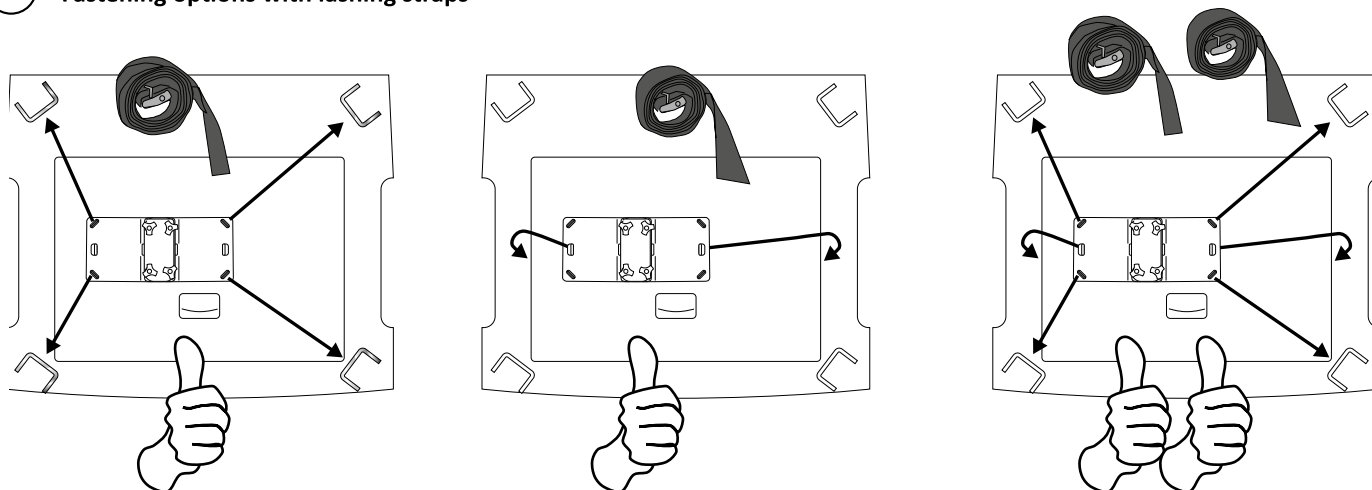

## 9 Insert lashing straps

A: Middle (wide) lashing strap

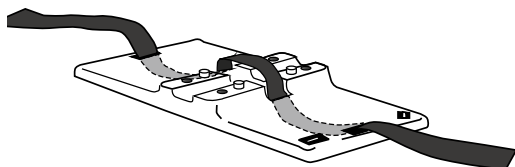

B: Outer (narrow) lashing straps

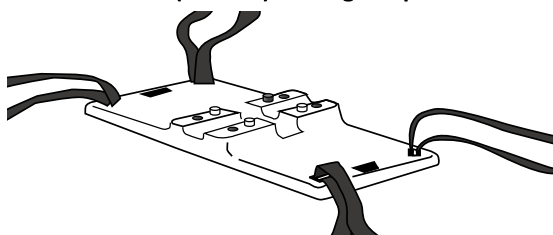

## 10 Installation of bottom panel - divider

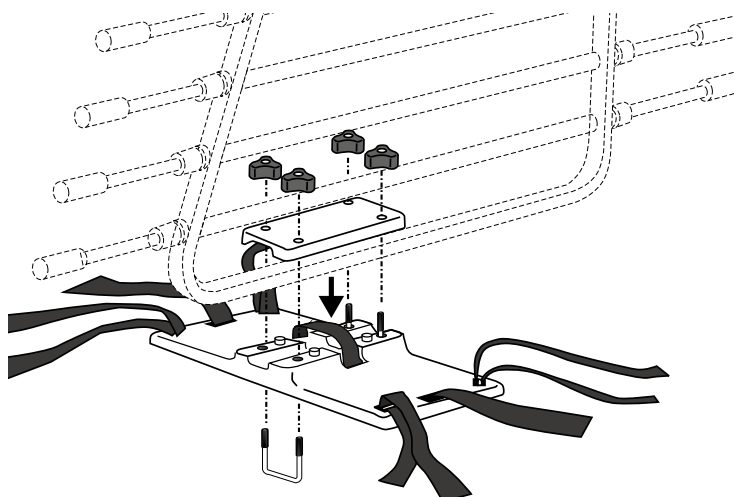

# INSTALLATION INSTRUCTIONS

## Additional bottom panel not included in the scope of delivery

11

**OPTIONAL:** If the divider is still not solid enough upon tightening, we recommend to order an additional bottom panel – item no.: 10001435

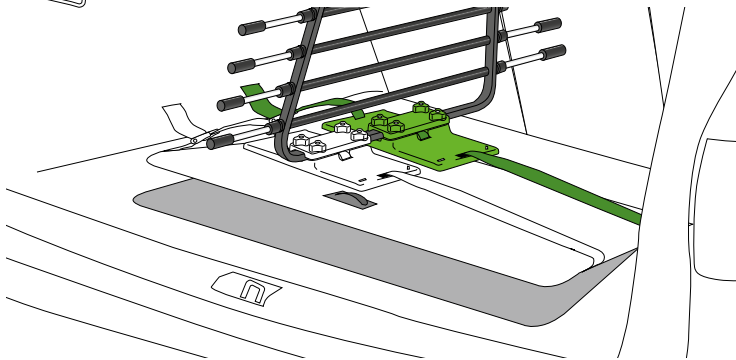
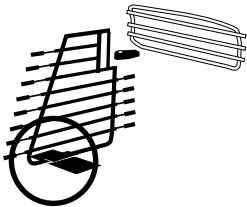

### Parts Additional bottom panel

- 2a. Base plate lower part \_ 1x
- 2b. Base plate upper part \_ 1x
- 3. Knurled nuts \_\_\_\_\_ 4x
- 4. U-bolt M8 \_\_\_\_\_ 2x
- 5a. Wide lashing strap \_ 1x

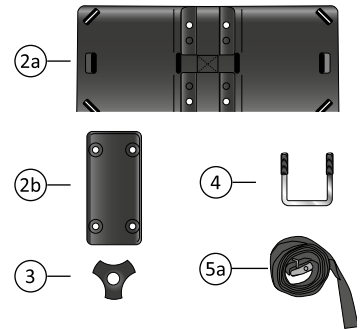

12

**Tension middle (wide) lashing strap under the bottom flap**

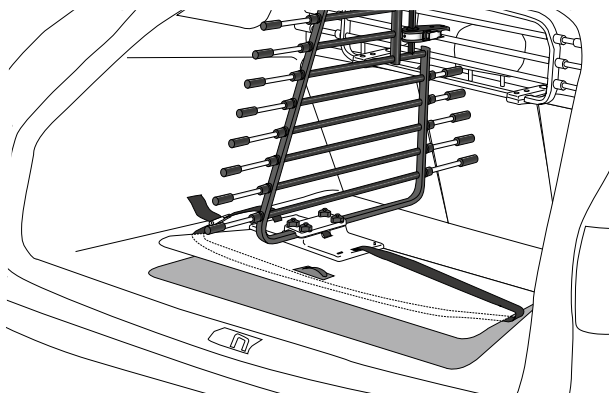

13

**Tension outer (narrow) lashing straps to loading hook**

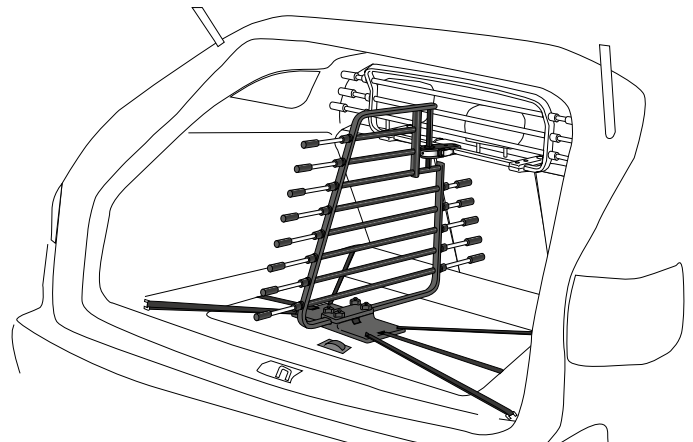

14

**Adjust telescopic bars - ATTENTION: keep distance to tailgate – do not keep any distance to rear seats!**

If the tailgate is touched although the bar is completely retracted, remove lower bars.  
**IMPORTANT: Screw on sleeve again afterwards!**



**Towards tailgate WITH distance!**

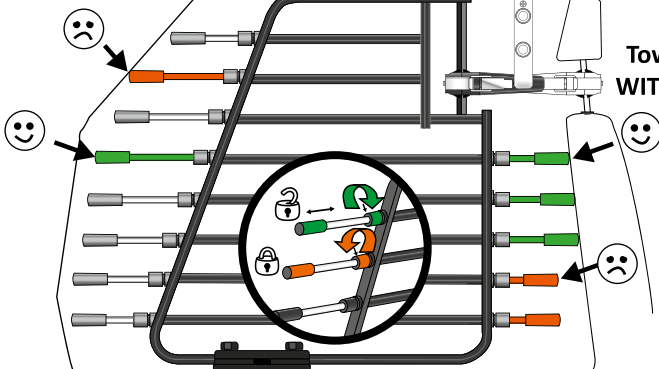

**Towards rear seats WITHOUT distance!**

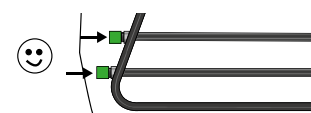
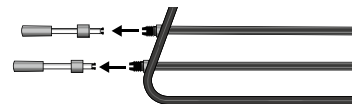
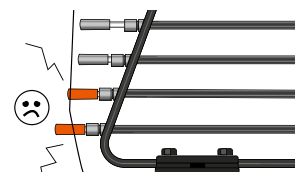



# INSTALLATION INSTRUCTIONS

## 15 With floor mat (e.g. rubber mat, item no. 95000000)

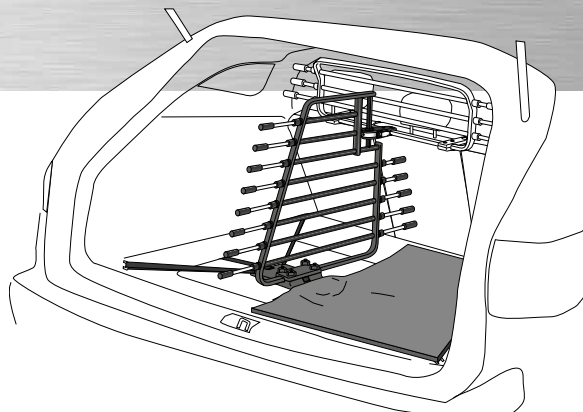
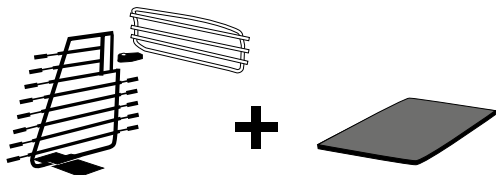

## 16 With car boot lining (e.g. STARLINER)

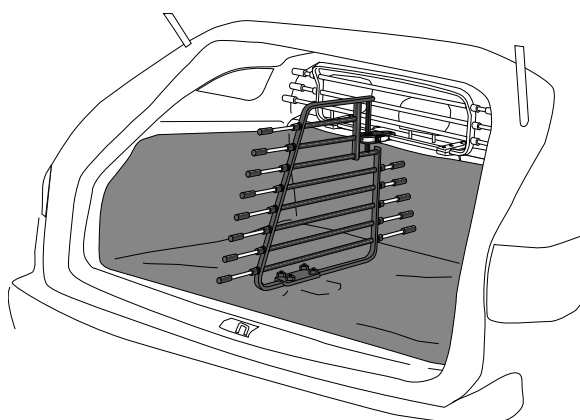
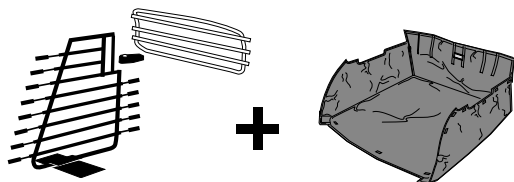

## 17 With car boot lining – cut clean mounting plate

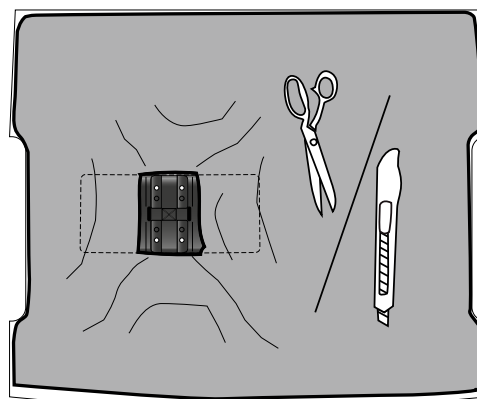
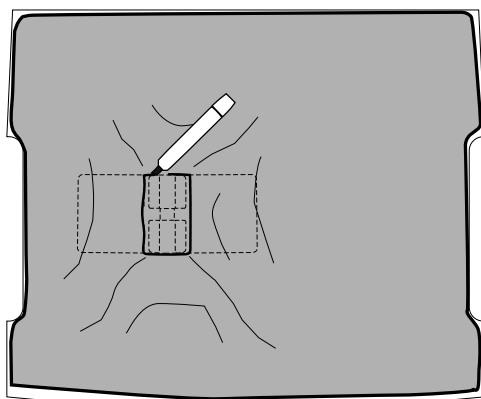

### General notes:

Make sure that the divider is safely positioned in the vehicle and that all the mounting parts are fixed tight.

To avoid damage, it is recommended to place a cover over the lashing straps (e.g. a rubber mat or Starliner car boot lining). If the divider is not needed, it can be easily removed from the separating grid "ROADMASTER DELUXE" by loosening the lashing straps and the clamping bracket (quick release).

### Safety instructions:

Always secure heavy load with additional tensioning straps. Before travelling, check all the mounting parts for tight fit. Check and retighten lashing straps in regular intervals. The transport of people behind the guard is prohibited. Never leave pets alone and unattended in the car. Before fitting the divider, remove any emergency kit such as warning triangle, first-aid kit, etc. from the boot floor compartment and store it in another easily accessible place. The divider is only intended for use in passenger cars.

### Cleaning instructions:

Use neutral soap lye to clean the divider and all the mounting parts especially from dog saliva and dog hair from time to time.

### Maintenance instructions:

Carry out visual inspections on the divider in regular intervals and replace damaged parts immediately if necessary.